

HOMES 3501-4001

1 BEDROOM, 1 BATH

INDOOR: 515-517 sf

OUTDOOR: 51 sf

TOTAL: 566-568 sf

FEATURES

- 1 Expansive North facing views overlooking Metrotown's vibrant downtown and the Northshore mountains.
- 2 Large entry closet adds extra storage.
- 3 Laminate flooring throughout main living areas and the bedroom.
- 4 8'8" ceiling height and 9'10" ceiling height on level 40.
- 5 AC throughout your home keeps you comfortable year-round.
- 6 Spacious kitchen island with storage and dining-style seating. 📍
- 7 Single slab porcelain backsplash is seamlessly lit by undercabinet LED lighting.
- 8 Tub with tile surround and shower wand.
- 9 Private balcony extends your living space outdoors and includes a natural gas outlet for your BBQ.
- 10 Appliance Package:
 - Miele 24" stainless steel 4-burner gas cooktop
 - Miele 24" stainless steel wall oven
 - Fulgor Milano 24" integrated refrigerator
 - Fulgor Milano 24" integrated dishwasher
 - 24" Faber hood fan with 400 CFM
 - Microwave with trim kit
 - 24" stacking Blomberg washer and dryer.
- 11 Access to outdoor and in-building amenities as exciting as the neighbourhood these homes are in.

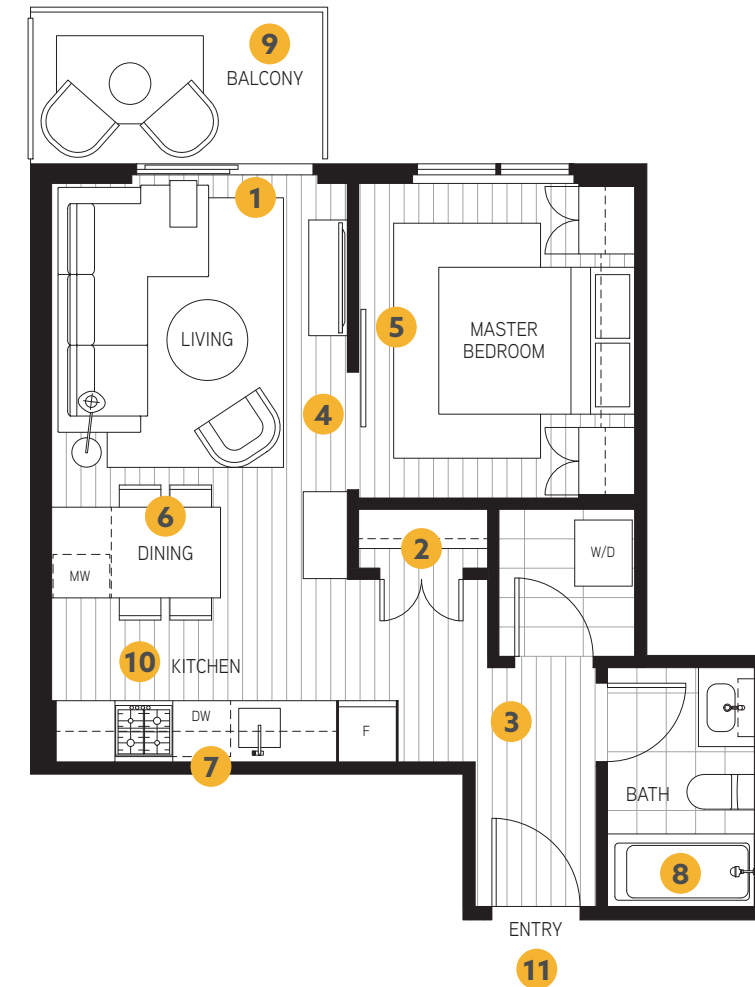

See the Features sheet for the full list of features enjoyed by every home at Telford on the Walk



Information contained herein is correct at the time of publication, but is subject to change without notice. Pictures, drawings, and digital renderings are for illustrative purposes only and should not be relied upon. E.&O.E. Sales & Marketing by Intracorp Realty Ltd. Telford Avenue Project Limited Partnership.



LEVEL 35-40



NORTH

